

MEMS Capacitive Accelerometer

ASC OS-215LN-PG

Biaxial
 MEMS Capacitive
 Measurement Range: ± 2 to ± 400 g
 Noise Density: 7 to 400 $\mu\text{g}/\sqrt{\text{Hz}}$
 Frequency Range ($\pm 5\%$): DC to 1000 Hz
 Stainless-Steel Housing (IP68)

Made in Germany



CE

MEMS Capacitive Accelerometer

The key components in capacitive accelerometers are high-quality micro-electro-mechanical systems (MEMS) that feature excellent long-term stability and reliability. This technology enables the measurement of static (DC) and constant accelerations, which can be used to calculate the velocity and displacement of moving objects. Depending on the design of the spring-mass-damping system, however, it is also possible to detect dynamic (AC) accelerations with amplitudes up to ± 400 g and within a frequency response range of up to 1 kHz ($\pm 5\%$) or 4.2 kHz (± 3 dB). Other advantages of capacitive accelerometers are their outstanding temperature stability, excellent response behavior and achievable resolution.

Description

The accelerometers of type ASC OS-215LN-PG are based on proven MEMS technology and capacitive operating principle. The integrated electronic circuitry enables a differential analog voltage output (± 4 V FSO) and flexible power supply voltage from 6 to 40 VDC. The LN (Low Noise) accelerometers from ASC provide an outstanding noise performance from 7 to 400 $\mu\text{g}/\sqrt{\text{Hz}}$ which is essential for demanding measurements of smallest frequencies and amplitudes.

The sensors feature a robust, reliable stainless-steel housing with protection class IP68 and an integrated cable with configurable length and connectors.

The hermetically sealed housing of the accelerometers is ideal for very harsh environmental conditions, e.g. bogie stability tests and monitoring applications in rail transport or condition monitoring of vehicles and their components in the construction sector.

Features

- Very Low Noise Differential Voltage Output
- DC Response, Gas damped
- High Shock Resistance
- Excellent Offset and Scale Factor Stability

Options

- Customized Cable Length
- Customized Connector
- TEDS Module
- V4A Stainless-Steel Housing

Applications

- Railway Engineering
- Condition Monitoring
- Structural Health Monitoring

More applications in several markets are figured out on our web page www.asc-sensors.de

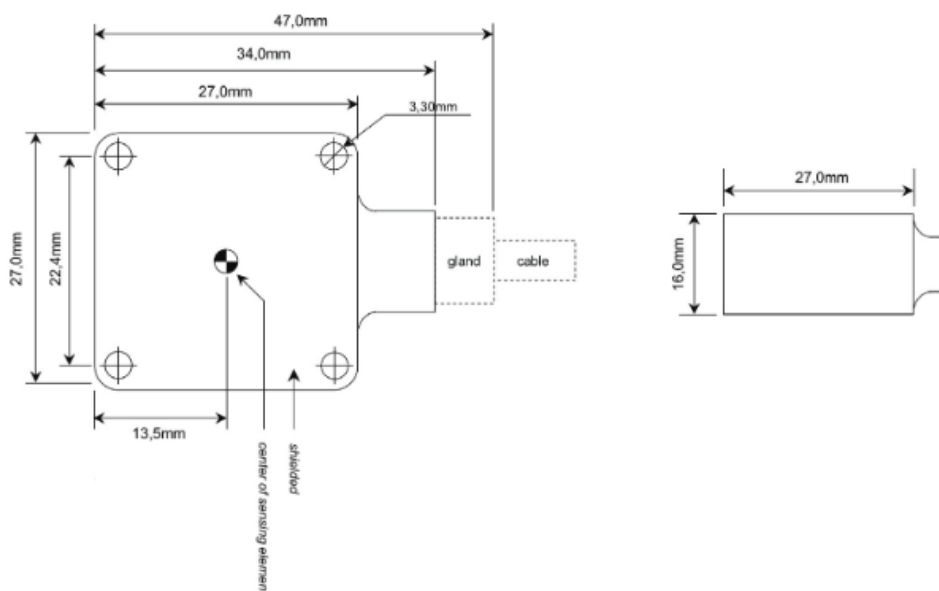

Typical Specification

Dynamic

Measurement Range	g	±2	±5	±10	±25	±50	±100	±200	±400
Scale Factor (sensitivity)	mV/g	2000	800	400	160	80	40	20	10
Noise Density	µg/√Hz	7	12	18	25	50	100	200	400
Min. Frequency Response Range (±5 %)	Hz	0 to 100	0 to 100	0 to 300	0 to 500	0 to 650	0 to 650	0 to 1000	0 to 1000
Max. Frequency Response Range (±3 dB)	Hz	0 to 525	0 to 800	0 to 1100	0 to 1750	0 to 2100	0 to 3000	0 to 3600	0 to 4200
Amplitude Non-Linearity	% FSO	<0.15 (typ) <0.5 (max)							
Transverse Sensitivity	%	<2 (typ) <3 (max)							

Electrical

Power Supply Voltage	V	6 to 40							
Operating Current Consumption	mA	<10							
Offset (bias)	mV	±80	±80	±40	±40	±40	±40	±40	±40
Broadband Noise (over min frequency range ±5 %)	µV	140	95	125	90	100	100	125	125
Output Impedance	Ω	90							
Isolation	Integrated electronic circuitry is isolated from the sensor housing Sensor housing and cable shielding are internally connected								

Environmental

Temperature Coefficient of the Scale Factor (max)	ppm/K	±200							
Temperature Coefficient of the Offset (max)	mg/K	±0.8	±2	±4	±10	±20	±40	±80	±160
Operating Temperature Range	°C	Standard Cable: -40 to +100 Optional with seawater resistant Cable K3: -15 to +70							
Storage Temperature Range	°C	-55 to +125							
Shock Limit (max peak)	g	2000	2000	5000	5000	5000	5000	5000	5000
Protection Class	IP68 (test conditions: hydrostatic head 3 m, duration 30 min, DUT powered) Please note: the housing is hermetically sealed and therefore not repairable.								

Physical

Sensing Element	MEMS Capacitive								
Case Material	Standard: Stainless-Steel V2A (material number 1.4301) Optional: Stainless-Steel V4A (seawater resistant, material number 1.4404)								
Connector at Cable End	Optional								
Mounting	Adhesive Screw Holes								
Weight (without cable)	gram	68							
Cable (standard)	30 gram per meter AWG 30 Polyurethane (PUR) Diameter 4.5 mm								
Cable K3 (seawater resistant)	22 gram per meter AWG 30 Polyurethane (PUR) Diameter 3.75 mm waterproof, sea water resistance up to +60°C and 1 bar pressure								

Sensor Calibration

Factory Calibration (supplied with the sensor)

Part Number		#12054	#12054	#14514	#14523	#14527	#14527	#14531	#14531
Measurement Range (sensor)	g	±2	±5	±10	±25	±50	±100	±200	±400
Applied Frequency (min)	Hz	1	1	10	10	10	10	10	10
Applied Frequency (max)	Hz	100	100	300	500	650	650	1000	1000
Input Amplitude	m/s ²	5	5	50	100	200	200	200	200
Reference Frequency for Determination of Scale Factor	Hz	16	16	80	80	80	80	80	80

Calibration according DIN ISO 17025 (order separately)

Part Number		#14512	#14512	#14516	#14525	#14529	#14529	#14533	#14533
Measurement Range (sensor)	g	±2	±5	±10	±25	±50	±100	±200	±400
Applied Frequency (min)	Hz	0.5	0.5	10	10	10	10	10	10
Applied Frequency (max)	Hz	150	150	500	800	1600	1600	2000	2000
Input Amplitude	m/s ²	5	5	50	100	200	200	200	200
Reference Frequency for Determination of Scale Factor	Hz	16	16	80	80	80	80	80	80

Remarks:

- The conversion factor 1 g corresponds to 9.80665 m/s².
- If any other calibration procedure is required, don't hesitate to contact us. Our services include both factory calibration and calibration in accordance with DAkkS guidelines.
- Furthermore, sensors have to be calibrated regularly to ensure accurate and precise results. On request we will be glad to remind you of the next scheduled calibration of your sensors.

Standard Cable Code / Pin Configuration (8 Wire System) including separate Power Supply for all Axes

The standard sensitive directions of the biaxial sensor ASC OS-215LN-PG are the X-axis and Y-axis. Upon request all other combinations of sensitive directions are possible (X and Z or Y and Z) while the color code of the corresponding sensitive directions is always the same.

Pin	Color Code	Description
1 Supply +	Red/Violet	X-Axis: power supply voltage +6 to +40 VDC
2 Supply -	Black/Violet	X-Axis: power GND
3 Signal +	Green/Violet	X-Axis: positive, analog output voltage signal for differential mode
4 Signal -	White/Violet	X-Axis: negative, analog output voltage signal for differential mode
5 Supply +	Red/Grey	Y-Axis: power supply voltage +6 to +40 VDC
6 Supply -	Black/Grey	Y-Axis: power GND
7 Signal +	Green/Grey	Y-Axis: positive, analog output voltage signal for differential mode
8 Signal -	White/Grey	Y-Axis: negative, analog output voltage signal for differential mode
9 Supply +	Red	Z-Axis: power supply voltage +6 to +40 VDC
10 Supply -	Black	Z-Axis: power GND
11 Signal +	Green	Z-Axis: positive, analog output voltage signal for differential mode
12 Signal -	White	Z-Axis: negative, analog output voltage signal for differential mode

Cable shielding is provided as a tinned-copper braiding which is also internally connected to the sensor housing

MEMS Capacitive Accelerometer

Standard Cable Code / Pin Configuration (6 Wire System) including common Power Supply for all Axes

Standard sensitive directions of the biaxial sensor ASC OS-215LN-PG are the X-axis and Y-axis. Upon request all other combinations of sensitive directions are possible (X|Z or Y|Z) while the color code of the corresponding sensitive directions is always the same.

Pin	Color Code	Description
1	Supply +	Red Power: supply voltage +6 to +40 VDC
2	Supply -	Black Power: GND
3	Signal +	Green/Violet X-Axis: positive, analog output voltage signal for differential mode
4	Signal -	White/Violet X-Axis: negative, analog output voltage signal for differential mode
5	Signal +	Green/Grey Y-Axis: positive, analog output voltage signal for differential mode
6	Signal -	White/Grey Y-Axis: negative, analog output voltage signal for differential mode
7	Signal +	Green Z-Axis: positive, analog output voltage signal for differential mode
8	Signal -	White Z-Axis: negative, analog output voltage signal for differential mode

Cable shielding is provided as a tinned-copper braiding which is also internally connected to the sensor housing

Optional Cable Code / Pin Configuration (6 Wire System)

Standard sensitive directions of the biaxial sensor ASC OS-215LN-PG are the X-axis and Y-axis. Upon request all other combinations of sensitive directions are possible (X|Z or Y|Z) while the color code of the corresponding sensitive directions is always the same.

Pin	Color Code Cable Type K3	Description
1	Supply +	Red Power: supply voltage +6 to +40 VDC
2	Supply -	Brown Power: GND
3	Signal +	White X-Axis: positive, analog output voltage signal for differential mode
4	Signal -	Grey X-Axis: negative, analog output voltage signal for differential mode
5	Signal +	Yellow Y-Axis: positive, analog output voltage signal for differential mode
6	Signal -	Pink Y-Axis: negative, analog output voltage signal for differential mode
7	Signal +	Green Z-Axis: positive, analog output voltage signal for differential mode
8	Signal -	Blue Z-Axis: negative, analog output voltage signal for differential mode

Cable shielding is provided as a tinned-copper braiding which is also internally connected to the sensor housing

Cable Configuration

6 Wire System - 6L

Common power supply for all axes, no cable switch



8 Wire System - 8L (standard cable only)

Separate power supply for all axes, no cable switch



6 Wire System - 6L2

Common power supply for all axes, including cable switch

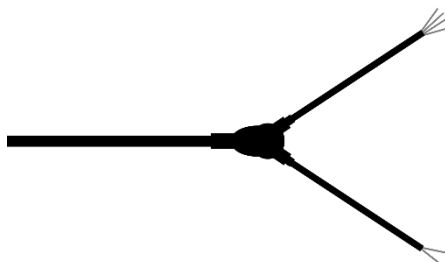

8 Wire System - 8L2 (standard cable only)

Separate power supply for all axes, including cable switch

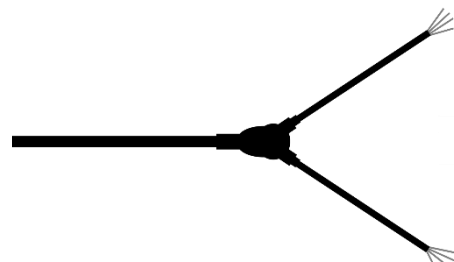

Ordering Information

Series	Model	Range [g]	Cable Length [m]	Connector & Pinout	Cable	Cable Configuration
ASC OS	-215LN-PG	002	6	A	K3	6L
		005				6L2
		010				
		025				
		050				
		100				
		200				
		400				

Example:

ASC OS-215LN-PG-002-6A-6L

Ordering information are based on standard configurations. All customized versions regarding connector and/or pinout will lead to a corresponding product match code:

- Standard length of the integrated cable is 6 meters. However, different customized cable lengths for all types of cables are possible on request.
- All versions have no connector at the cable end which is identified by "A" in the product match code. However, it is possible to assemble almost all connector types during production.
- Cable type identifier "K3" is not used within the ordering information when standard cable is requested.
- Applications where waterproof accelerometers are required, cable type K3 is suggested.
- Applications where seawater resistant accelerometers are required, cable type K3 is mandatory. In this case also the optional stainless-steel housing V4A (material number 1.4404) is recommended.
- The standard sensitive directions of the biaxial sensor ASC OS-215LN-PG are the X-axis and Y-axis. Upon request all other combinations of sensitive directions are possible (X and Z or Y and Z).
- Cable configurations "8L" and "8L2" are only available when the standard cable is used.

Safety Precaution for Installing and Operating

This data sheet is a part of the product. Read the data sheet carefully before using the product and keep it available for future operation. Handling, electrical connections, mounting or any other work performed at the sensor must be carried out by authorized experts only. Appropriate safety precautions must be taken to exclude any risk of personal injury and damage to operating equipment as a result of a sensor malfunction.

Handling

The sensor is packaged in a reliable housing to protect the sensing elements and integrated electronic components from the ambient environment. However, poor handling of the product can lead to damages that may not be visible and cause electrical failure or reliability issues. Handle the component with caution:

- Avoid shocks and impacts on the housing, such as dropping the sensor on hard surface
- Never move the sensor by pulling the cable
- Make sure that the sensor is used within the specified environmental conditions
- Transport and store the sensor in its original or similar packaging
- The sensor should be mounted on a stable flat surface with all screws tightened or other mounting options
- When adhesives are used to mount the sensors, please select the corresponding products according to permanent or removable mounting, ambient temperature range as well as quality of the mounting surface
- Avoid any deformation during mounting the sensor
- Mounting tolerances may have an influence on the measured result

Electrical

ASC's inertial sensors are working with many established data acquisition systems. However, make sure that a proper DAQ is used, for the corresponding operation principle of the sensor. Furthermore, suitable precautions shall be employed during all phases of shipment, handling and operating:

- Active sensor pins are susceptible to damage due to electrostatic discharge (ESD)
- Make sure that the sensor is used within the specified electrical conditions
- Check all electrical connections prior to initial setup of the sensor
- An incorrect wiring of the signal or power supply connections will lead to damages of the sensor
- Completely shield the sensor and connecting cable according to your application
- Do not perform any electrical modifications at the sensor
- Do not perform any adaptations on the wiring or connectors while the device under power
- Never plug or unplug the electrical connection while the sensor is under power
- When a certain pin is not used during operation, make sure that the pin is insulated

Quality

- We have a quality management system according to **ISO 9001:2015**.
- The Deutsche Akkreditierungsstelle GmbH (DAkkS) has awarded to our calibration laboratory the **DIN EN ISO/IEC 17025:2018** accreditation for calibrations and has confirmed our competence to perform calibrations in the field of mechanical acceleration measurements. The registration number of the certificate is **D-K-18110-01-00**.
- The sensors described in the data sheet are **CE**-compliant.

Made in Germany



analyzing



monitoring



testing



measuring